

ADDITIONAL INSTRUCTIONS FOR STANDARD BI-FOLD CORNER DOORS

CT29 RTA 27.9.16

Follow standard 'L' shaped corner instruction sheet for carcass assembly but do not fit standard hinge plates until unit assembled.

Additional fittings for standard doors

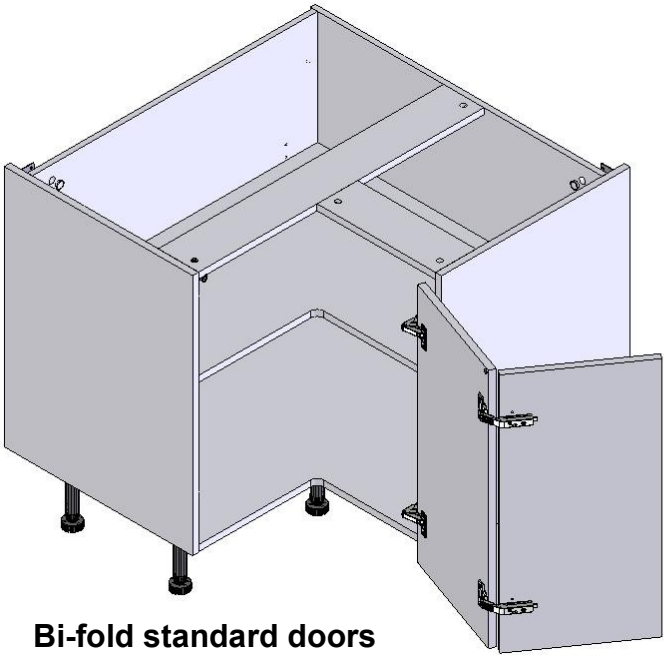
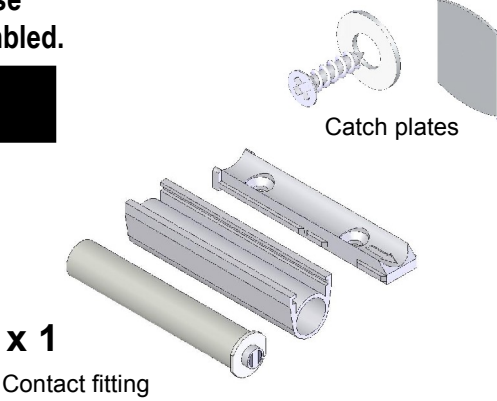
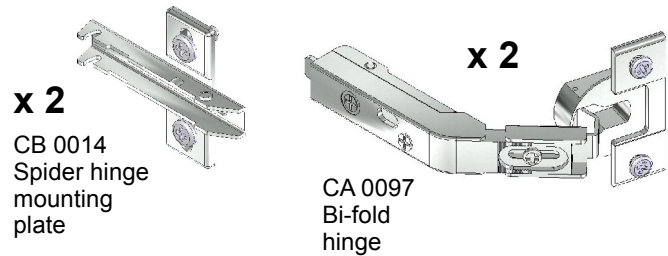

Bi-fold standard doors

1 Screw fix 2 standard hinge plates **J** to left or right hand end panel in positions shown.

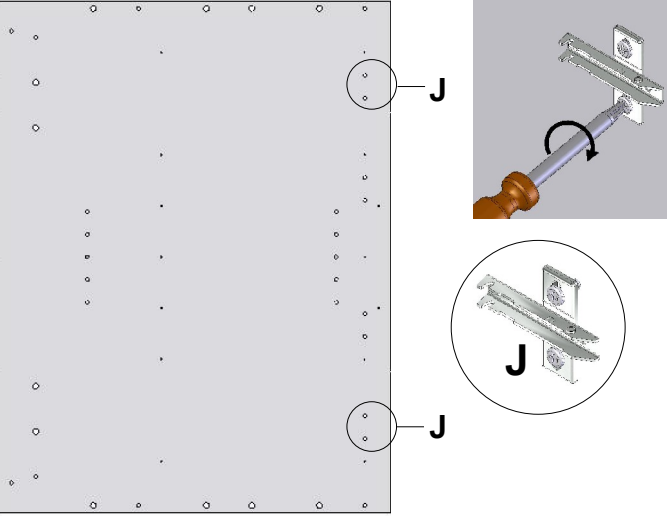

2 Screw fix standard hinges to first door with double drilling and fit door buffers to corners of door as shown.

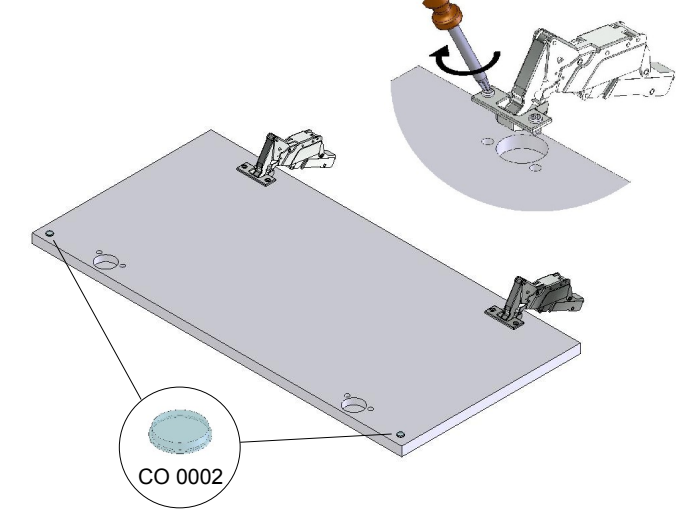

3 Clip hinges onto hinge plates. To release hinges from plates, lift the rear release clip as shown.

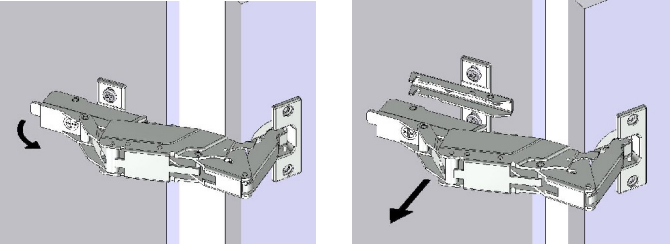

4 Fit bi-fpld hinges to second set of hinge holes on back of first door.

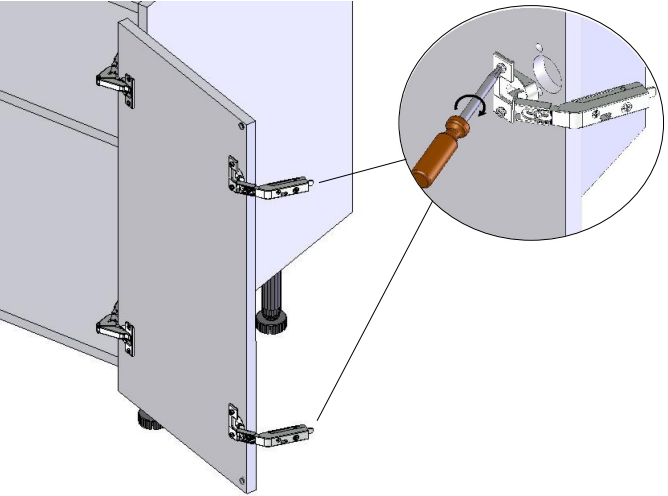

5 Fix hinge plates to back of second door as shown.

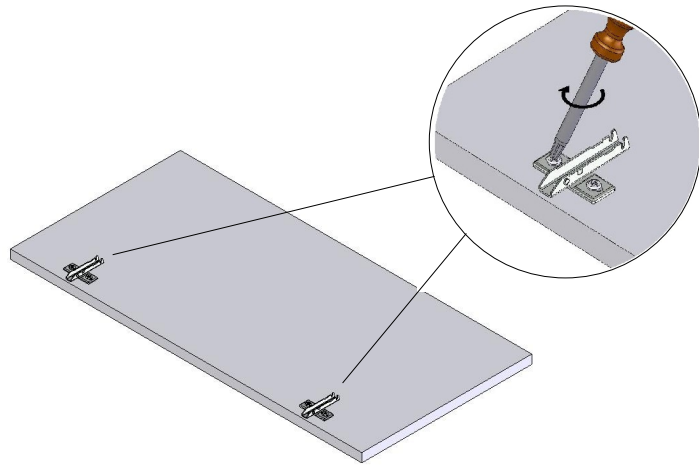

6 Clip bi-fold hinges onto plates on second door. Adjust hinges for level as on standard hinges.

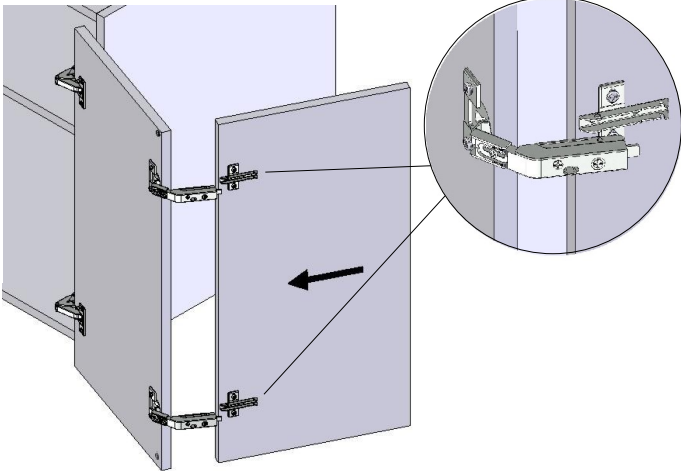

7 On standard opening doors bore first opening door and fit handle if required.

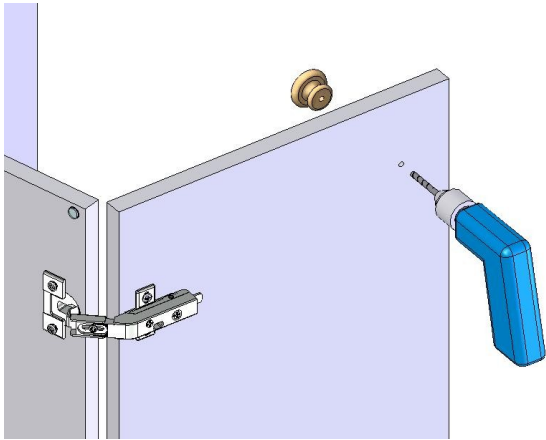

8 A contact fitting should be fitted to the underside of the top rail as shown.
Note: The fitting should be fitted after all unit doors have been fitted and fully adjusted.

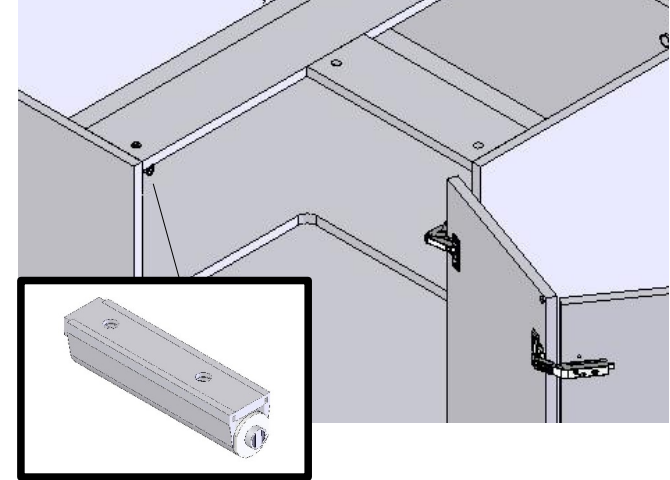

9 Screw fix contact fixing plate to underside of top rail in position shown using two screws provided.

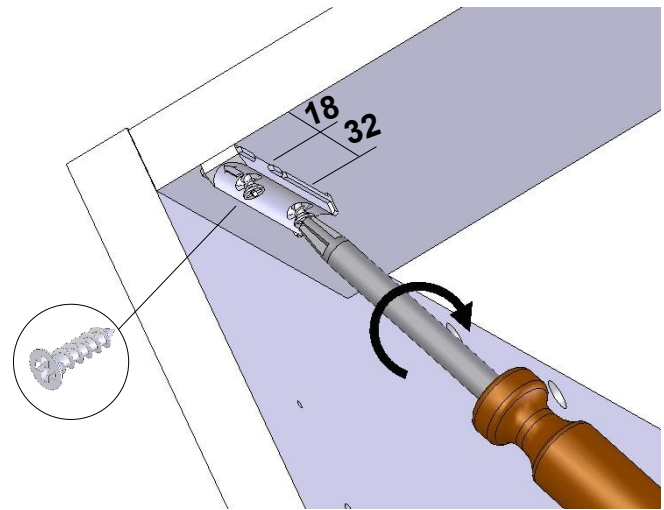

10 Slide contact housing into place on fixing plate.

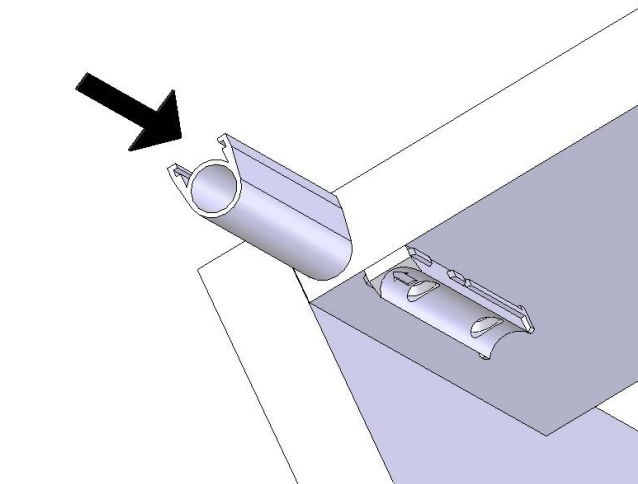

11 Slide contact piston into housing.

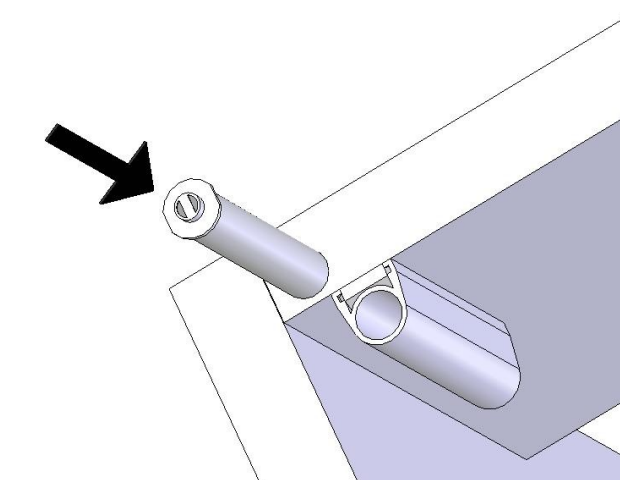

12 After fully adjusting the doors line – up catch plate with catch piston before screw fixing to back of door.

