

# BI-FOLD DOOR FITTING INSTRUCTION

CT34 2.10.18

## Components

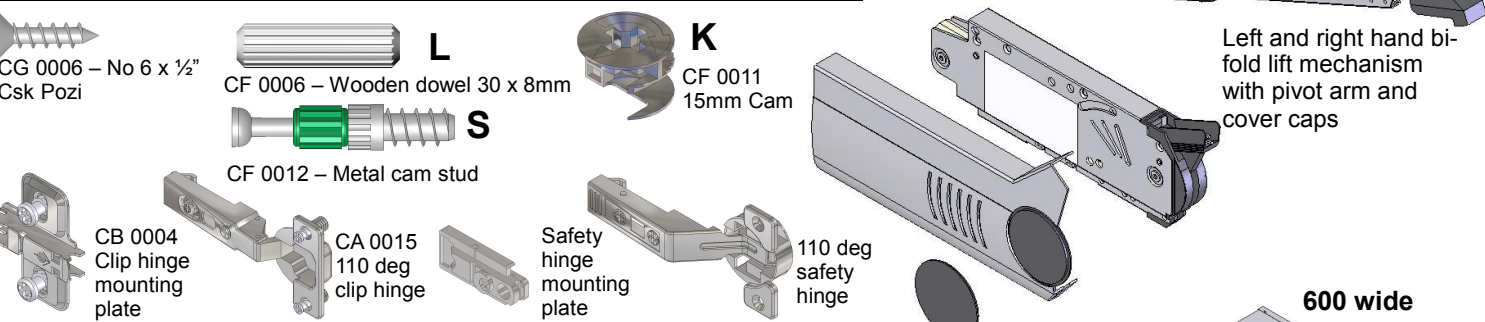

## Wall unit assembly 600 wide

When fitting bi-fold doors on the 600 wide unit, drill end panels as shown below for fitting the bi-fold system. Also drill wall unit top panel for hinges as shown opposite. Then follow standard wall unit instruction sheet for wall unit assembly.

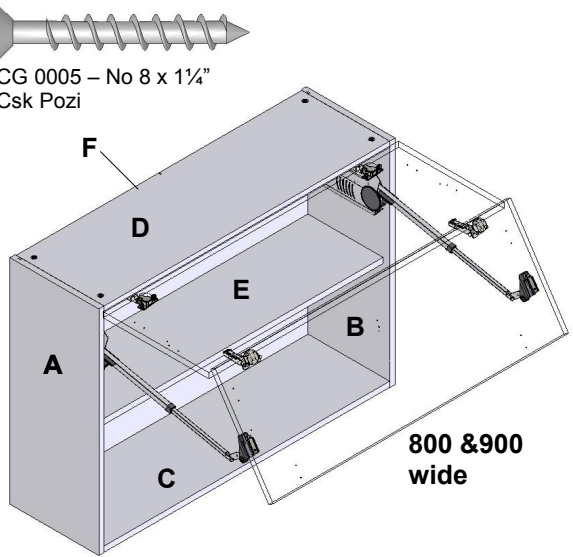
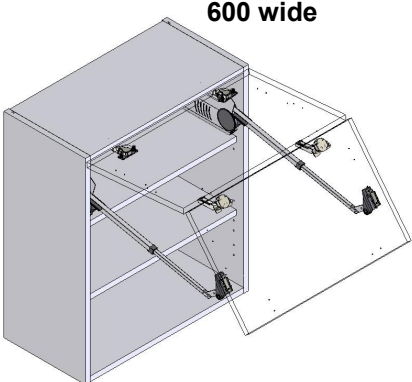
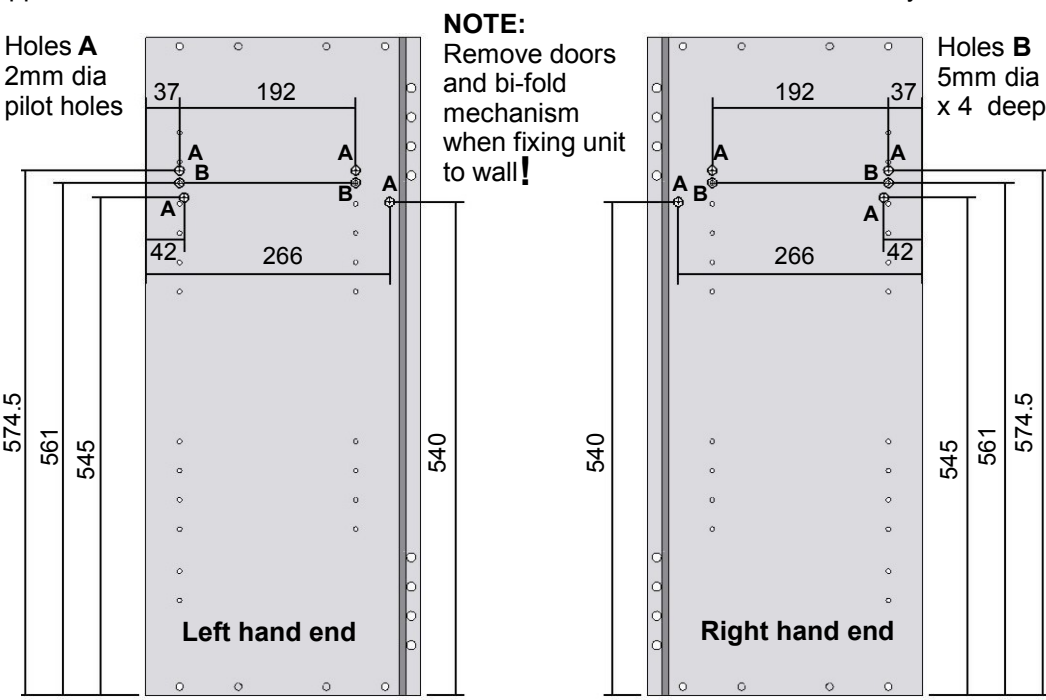

**Bi-Fold units are available in 600, 800 & 900 widths.**  
**Note:** The 600 wide unit uses a standard 600 wide wall cabinet and has only one lift-up mechanism which can be fitted on left or right. The 800 & 900 wide units have a different construction and have two lift-up mechanisms.

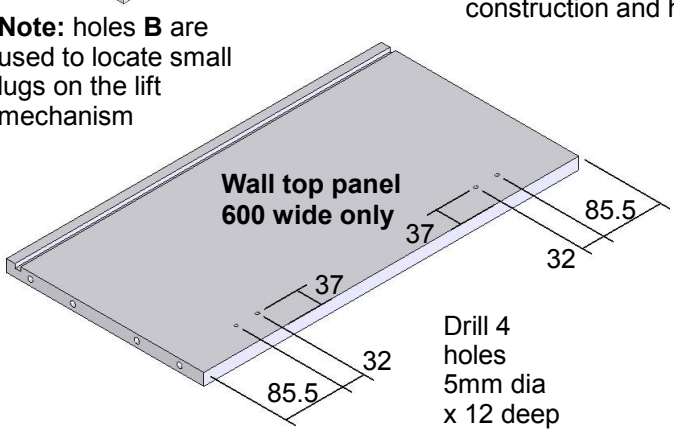

## Wall unit assembly 800 & 900 wide

**1** Fit the metal cam studs S to the end panels A and B in positions shown.

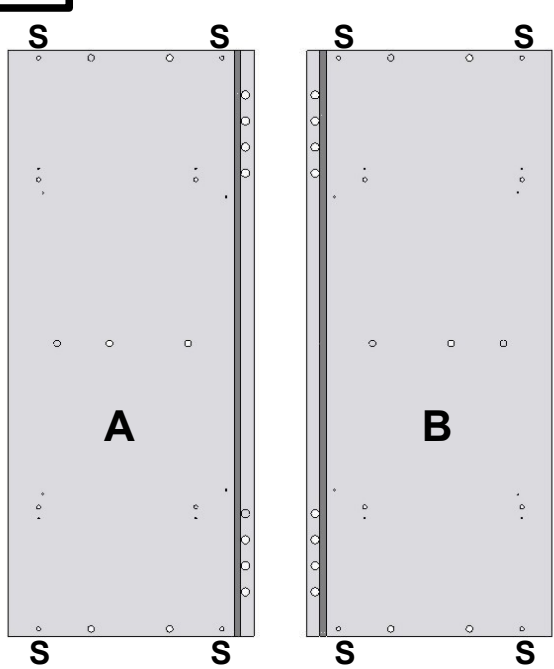

**2** Insert cams K and dowels L into holes in base C, top D, shelf E and rear support F. Turn base and top over and screw fix hinge plates and rear support cam studs S as shown.

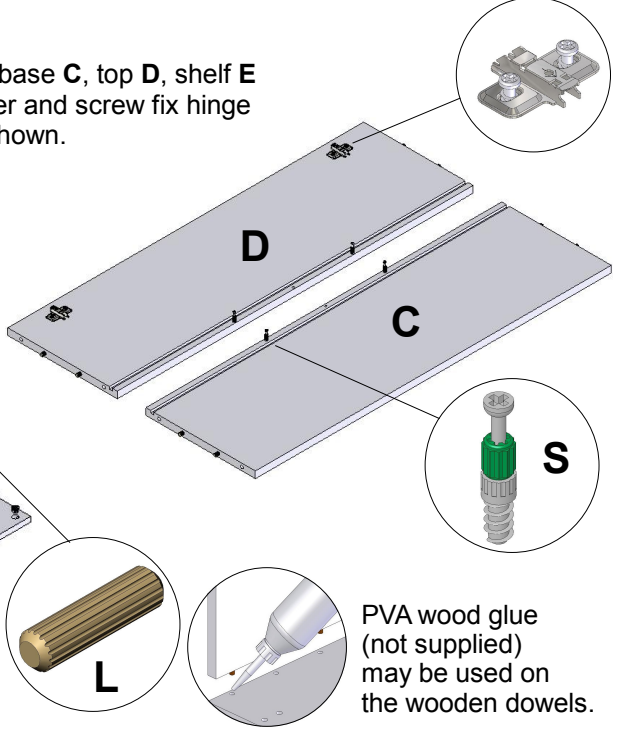
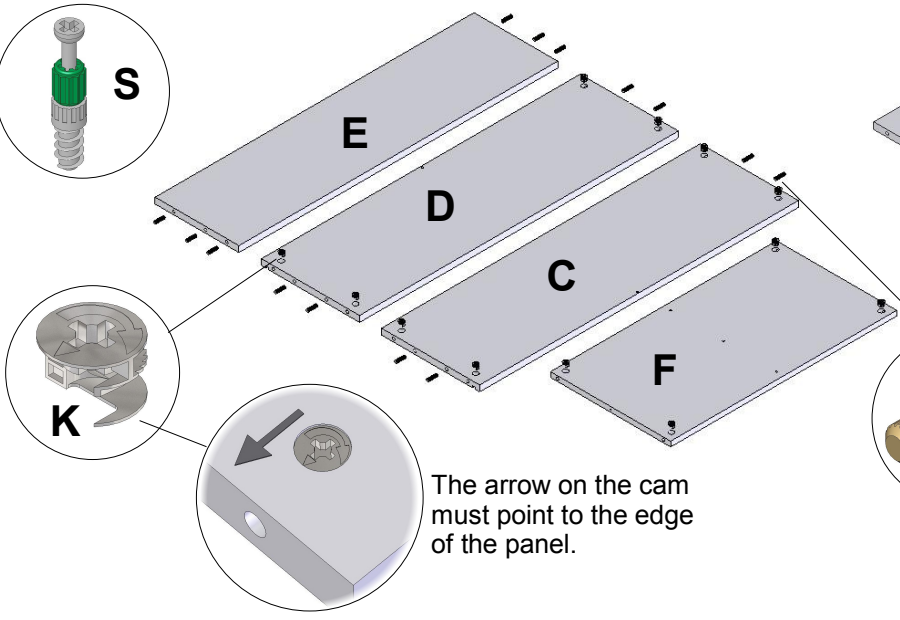

**3** Lay end panel B on a clean surface (the packaging is ideal). Position base panel C and back support panel F so the metal cam studs and wooden dowels line up with the holes and all 15mm cams are to the outside of the unit. Turn the 15mm cams clockwise with a suitable screwdriver (do not use an electric screwdriver).

**4** Position top panel C and shelf panel E as shown and turn cams with a suitable screwdriver.

**5** Slide back panel into place, the position side panel A above. Use a rubber mallet to tap the panels completely together to avoid damage to the cams and panels. Turn the cams with a suitable screwdriver.



CG 0005 – No 8 x 1¼" Csk Pozi

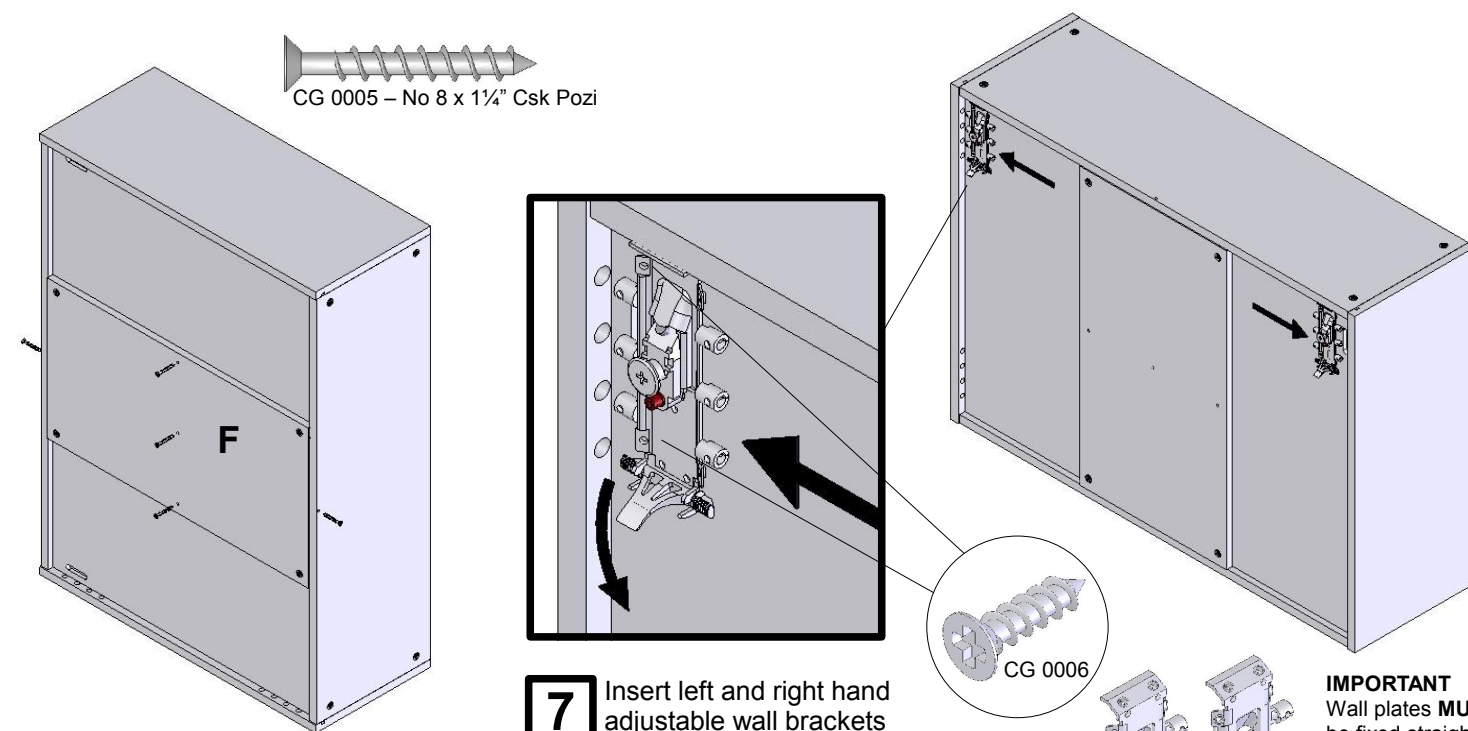

- 6** Screw fix through base and top panel into top and bottom edges of rear support panel **F**. Also screw fix through rear support panel **F** into back edges of shelf panel.

- 7** Insert left and right hand adjustable wall brackets into holes at rear of unit. Lock in place with rear lock clips and secure each bracket with screws as shown. A wall plate and cover caps are also supplied for use with the brackets.

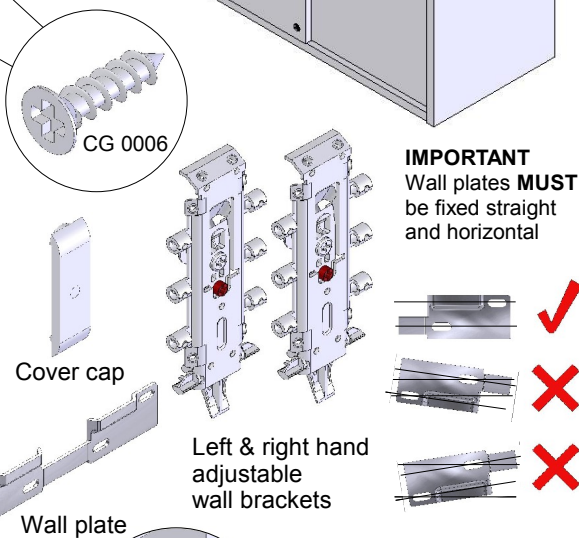

## Fitting bi-fold mechanism all unit widths

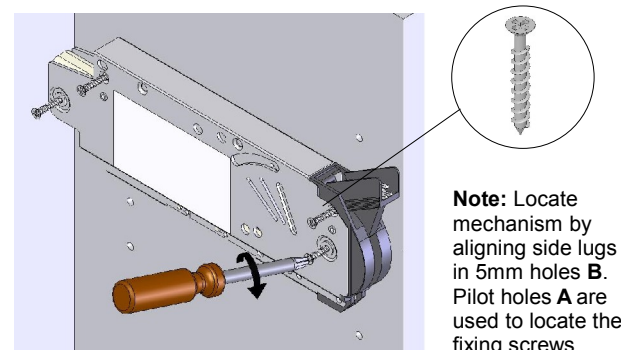

**Note:** Locate mechanism by aligning side lugs in 5mm holes **B**. Pilot holes **A** are used to locate the fixing screws.

- 8** Screw fix left and right hand bi-fold mechanisms to inner face of left and right wall unit end panels.

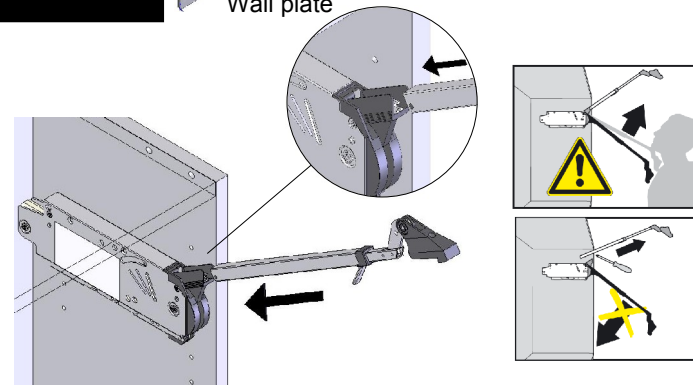

- 9** Clip telescopic arms into place on the lift mechanisms. **WARNING** There is a danger of injury if the telescopic arm springs upward. Remove the telescopic arm rather than pushing it down.

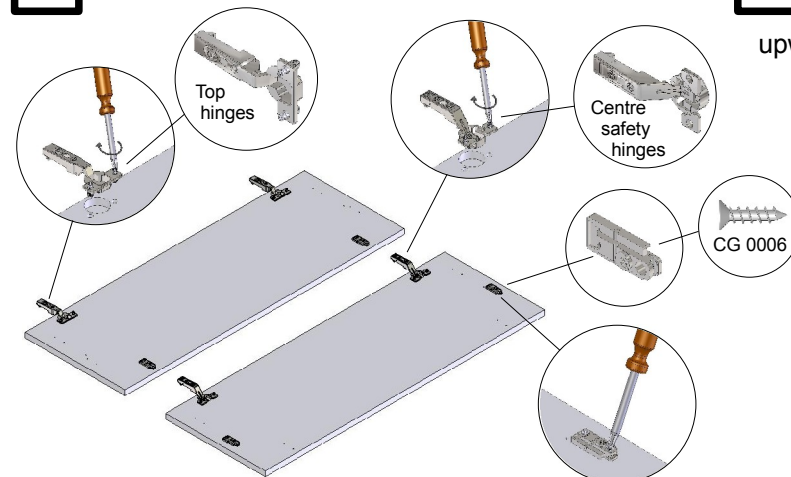

- 10** Screw fix top and centre safety hinges and centre hinge plates to back of bi-fold door as shown. Also fix hinge plates for telescopic arms.

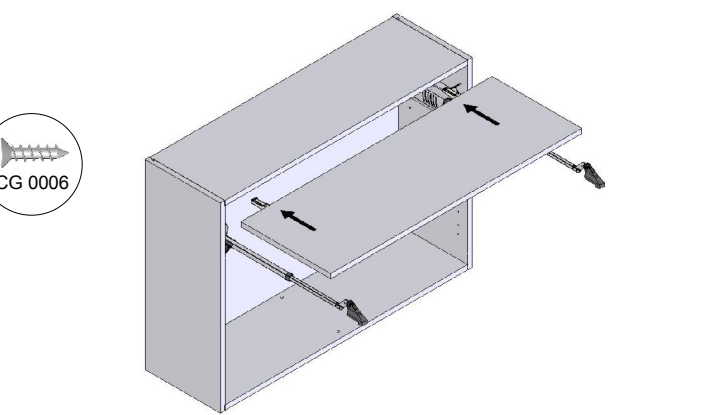

- 11** Place upper door above telescopic arms and clip top hinges onto hinge plates.

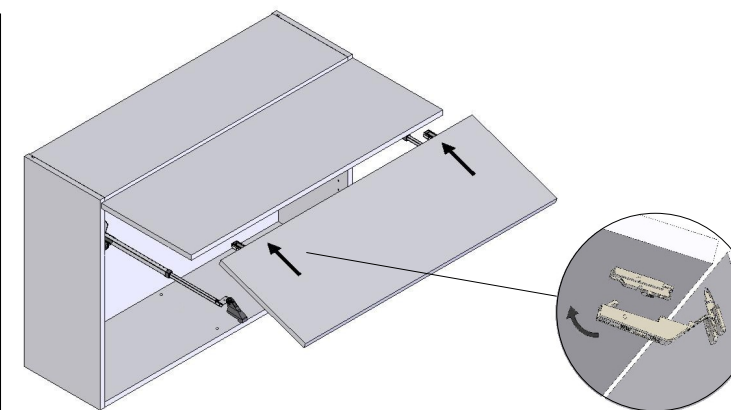

- 12** Connect upper and lower doors by clipping centre safety hinges onto hinge plates.

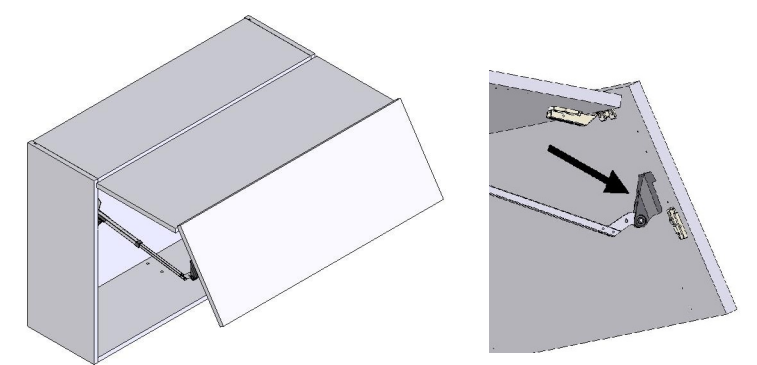

- 13** Clip telescopic arms onto hinge plates on rear of lower door.

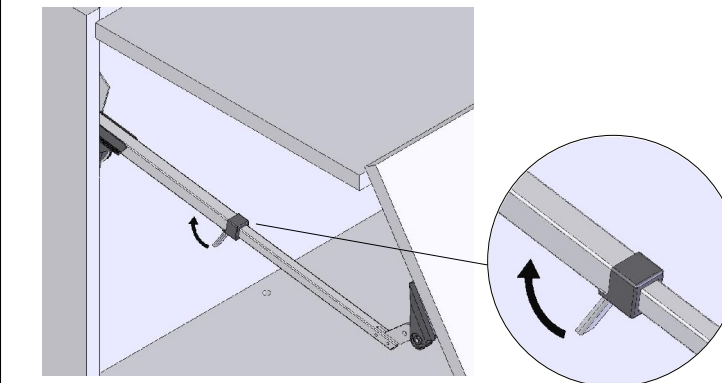

- 14** The telescopic arms adjust themselves by closing the doors. They are fastened using the centre lever. This process also adjusts the tensions in the doors.

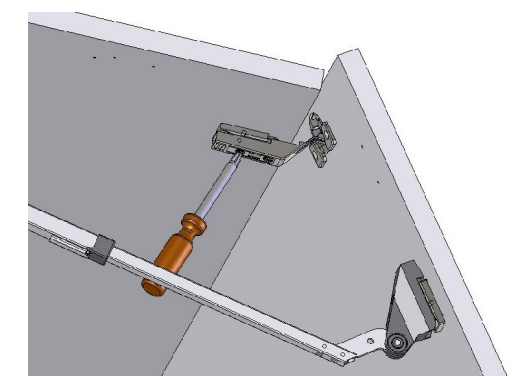

- 15** Set the desired gap between the doors by adjusting the position of the centre hinge on the hinge plate.

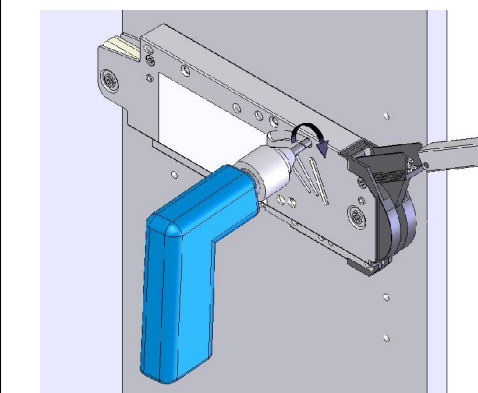

- 16** A power screwdriver can be used to properly set the lift mechanism. (Pozidriv, size 2, length 39mm) If the doors fall when let go, turn the adjuster clockwise.

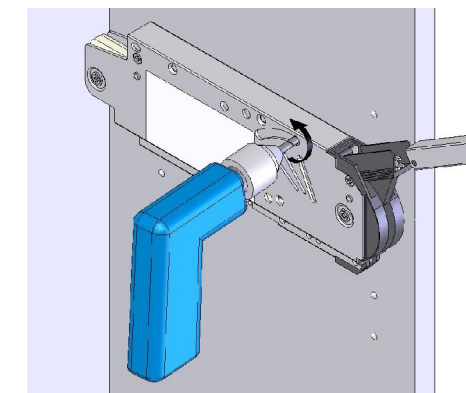

- 17** If the doors rise when let go, turn the adjuster anti-clockwise.

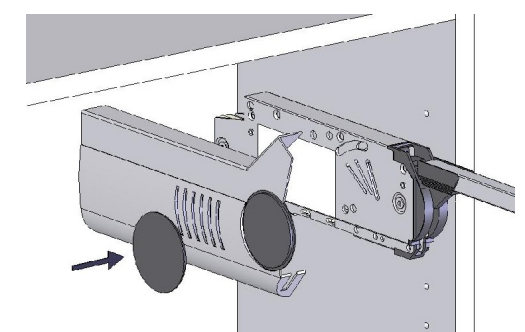

- 18** When all adjustments have been made, fit cover caps over left and right hand bi-fold mechanisms.

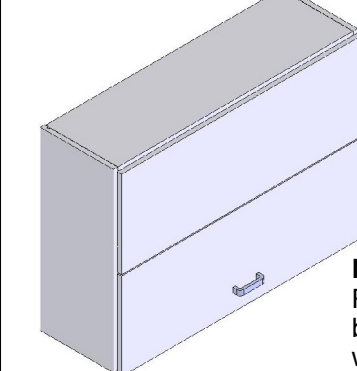

- 19** Fit handles to doors. Follow standard wall unit assembly sheet for wall fixing and fitting shelves.

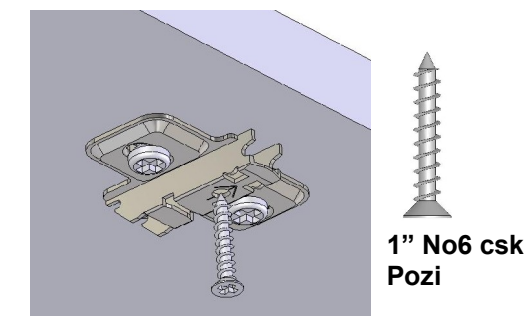

- 20** Fit Once the doors are fully adjusted it is important to fix an additional 1" No6 csk screw through the hinge plates located in the top panel and make sure the arm levers are locked in position before general use.

