

DRAWER BOX ASSEMBLY

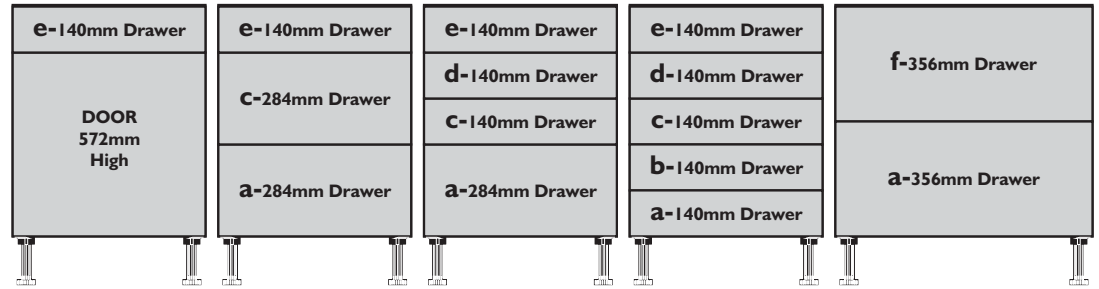

These illustrations show the drawer configurations for the base units. The letter code (a, b, c etc.) refer to the measurements on the drawing of the Base End Panel on the left. The measurements for the drawer runner positions on the Appliance Housings and Mid-height Units are the same as shown on the drawing of the Base End Panel. Refer to the illustrations on the Tall Unit Assembly Instructions for these units for the codes for the drawer runner positions.

↓ = Position of screws that go into pop-marks in the end panels of the Base Units.
 x2 /runner
 CG 0031-No.8x5/8" Csk Pozzi

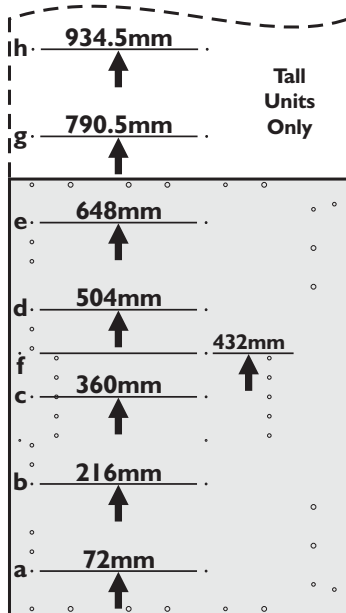
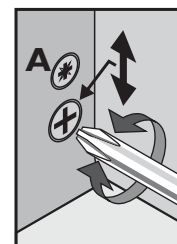
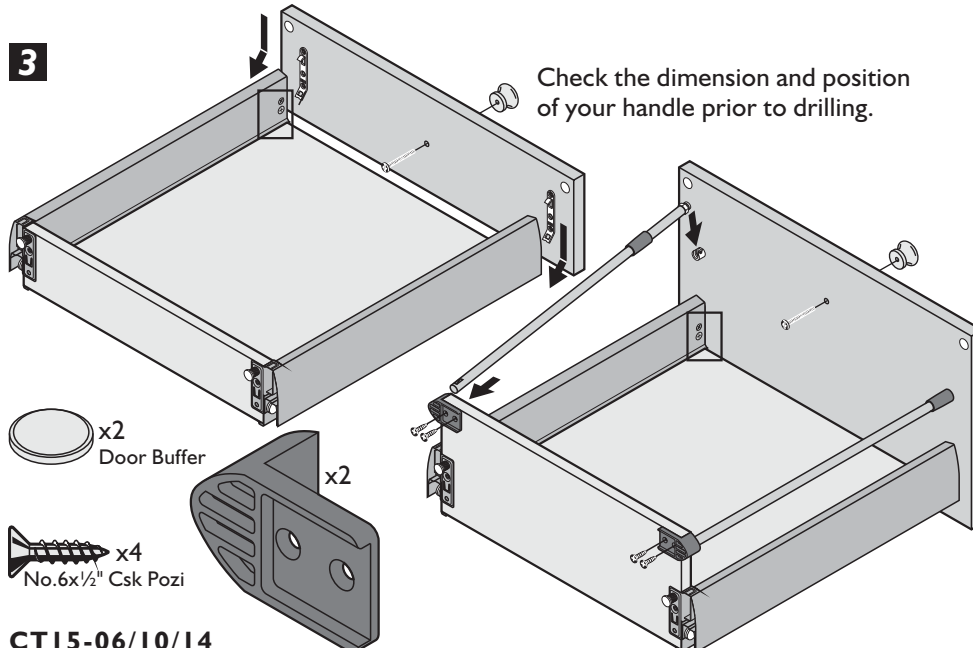
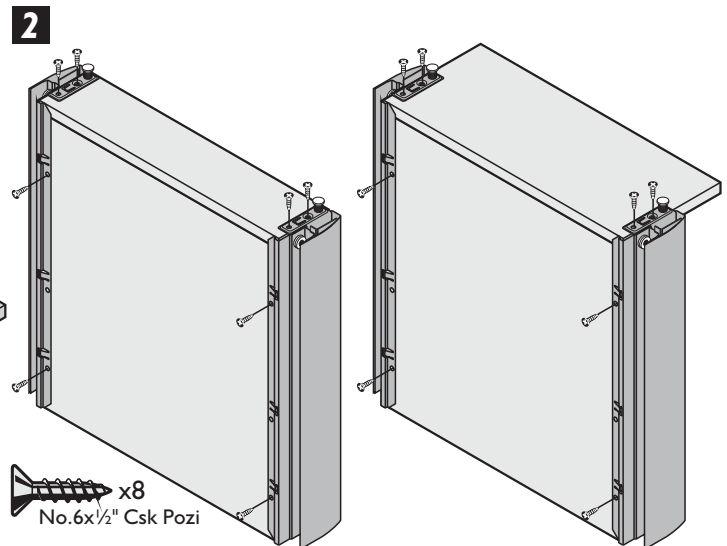
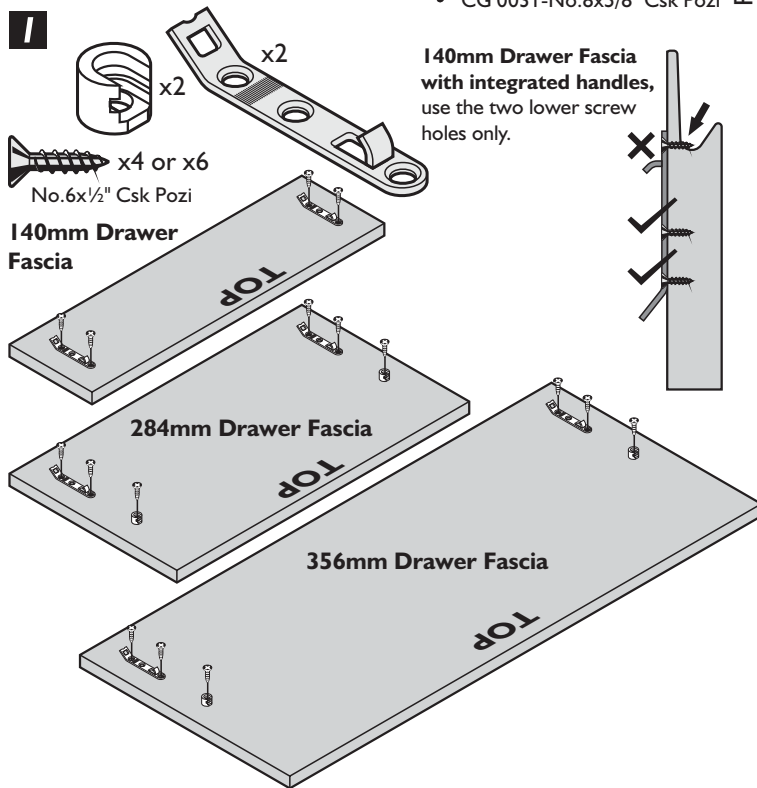
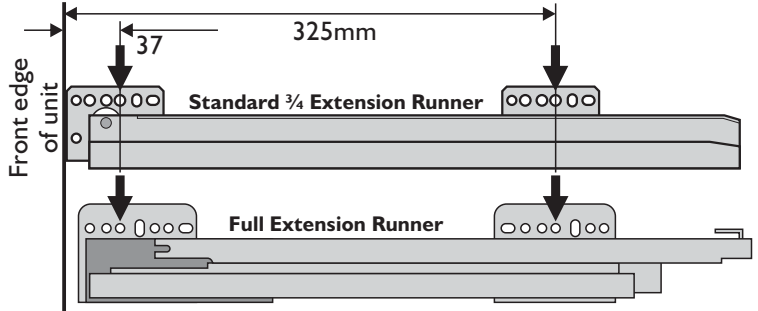

Vertical Adjustment

Loosen the top screw 'A' before adjusting fascia. Tighten again afterwards.

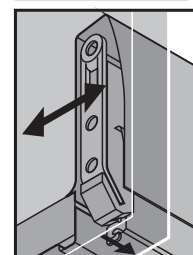

Horizontal Adjustment and Fascia Removal

Push the small lever backwards to release the bracket on the fascia. Either move the fascia as necessary and release the lever or remove the fascia..

PULL-OUT DRAWERS

Internal Drawer Fascia

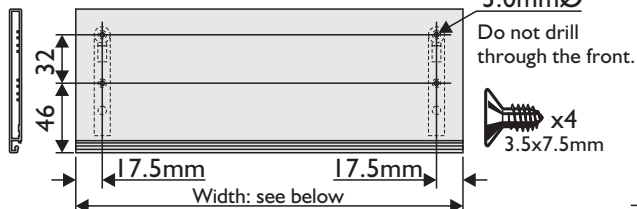

Cabinet Width	Frontal Width
300mm	256
400mm	356
450mm	406
500mm	456
600mm	556

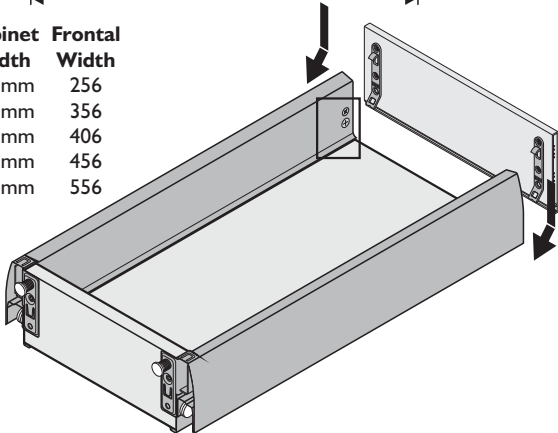

Internal Drawers are fitted in two ways:

Internal Drawers with a special fascia which is behind the exterior fascia.
Pull-out Drawers where the exterior fascia is attached to the drawer front. This is always a Pan Drawer box and includes the rails.
Follow the instructions on the other side for fixing the bracket and mount for the rails to the doors. Mark the back of the doors with a bradawl in the positions shown.

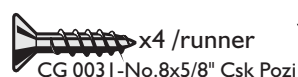
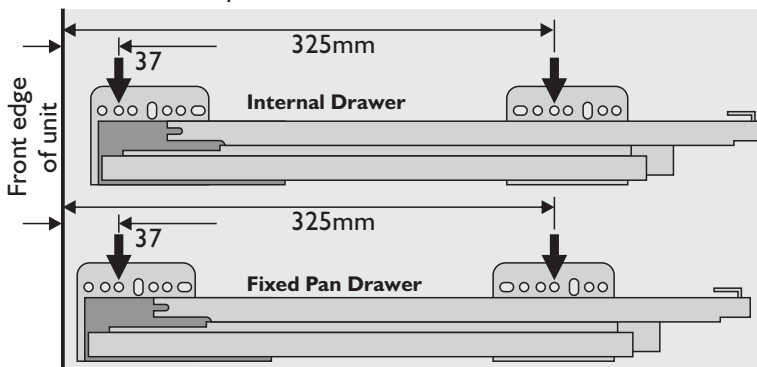

= Position of screws that go into pop-marks in the end panels of the Base Units.

Larder units require marking with a bradawl in the positions indicated below.

BASE UNITS

Type 1
1 Working Top Drawer
1 Internal Drawer
1 Fixed Pan Drawer

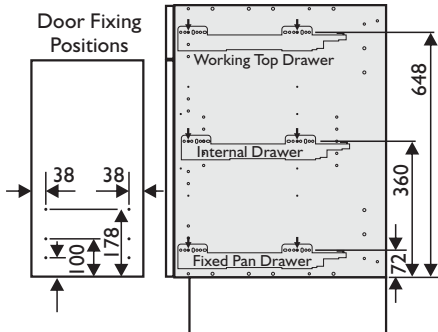

Type 2
2 Fixed Pan Drawers

Door Fixing Positions

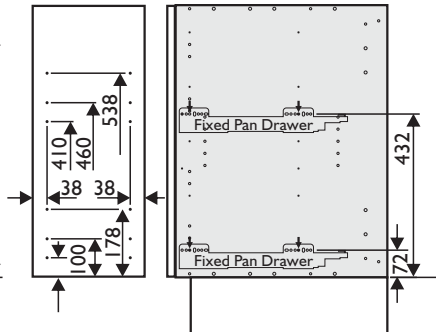

Type 3*
2 Internal Drawers
(Door hinged as usual)

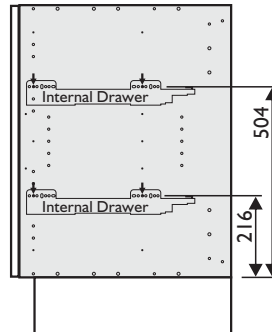

* Important:

Replace the standard hinges on these units with the supplied Zero Protrusion where a door is over the Internal Drawers.

LARDERS

Type 1
4 Internal Drawers
3 Fixed Pan Drawers

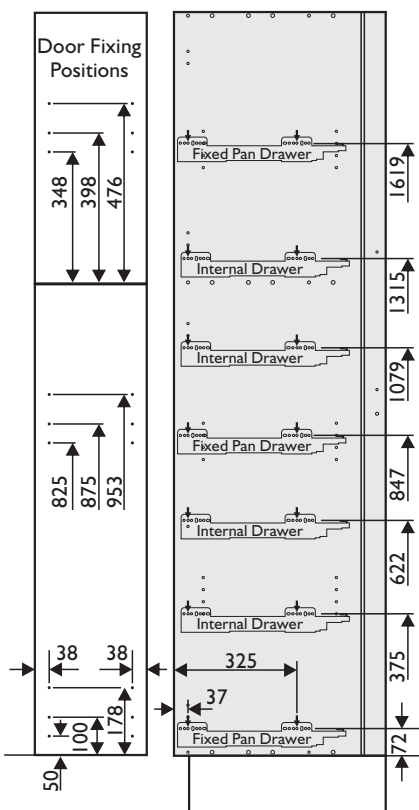

Type 2
Hinged Top Door
3 Internal Drawers
2 Fixed Pan Drawers

Door Fixing Positions

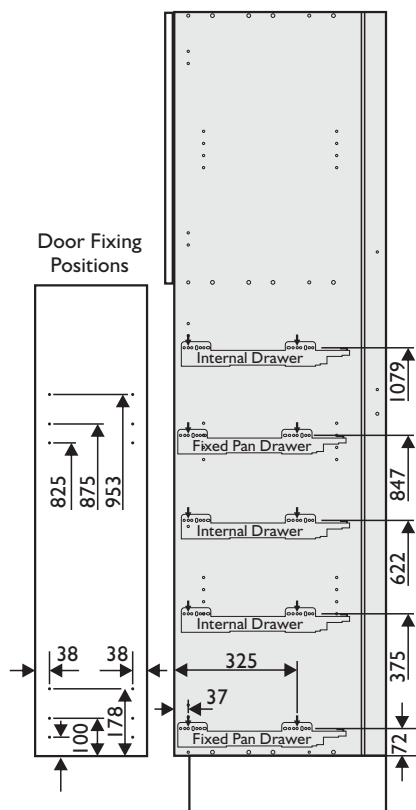

Type 3*
Hinged Doors
6 Internal Drawers

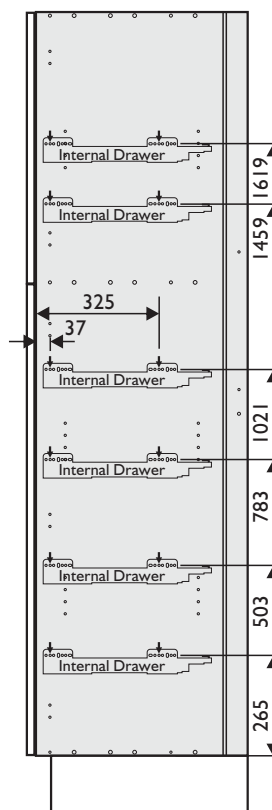

Type 4*
Hinged Doors
4 Internal Drawers

