

# WALL UNIT ASSEMBLY INSTRUCTIONS

## Fitting Identification List

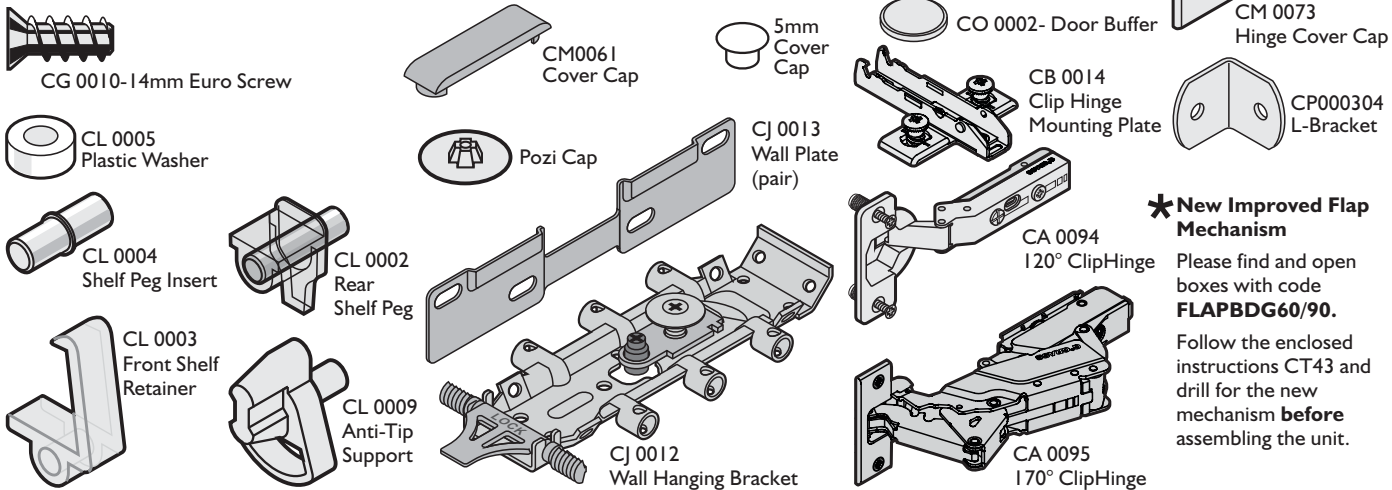
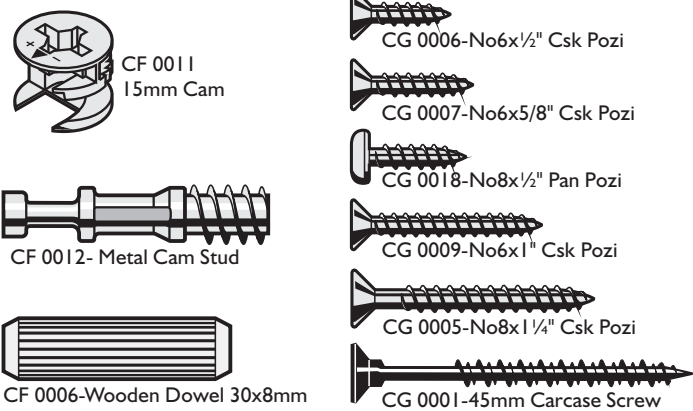

**\*New Improved Flap Mechanism**  
Please find and open boxes with code **FLAPBDG60/90**.  
Follow the enclosed instructions CT43 and drill for the new mechanism **before** assembling the unit.

## 15mm Cam & Metal Cam Stud

- Fix the metal cam studs into the end panels in the holes indicated with a letter 'S'.
- Put the 15mm cams into the panels and rails with the arrow pointing to the edge of the panel.
- Lay the other panel on a clean surface (the packaging is ideal).
- Position the first panel so the metal cam studs and wooden dowels line up with the holes and all 15mm cams are to the outside of the unit
- PVA wood glue (not supplied) may be used on the wooden dowels.
- Use a rubber mallet to tap the panels completely together to avoid damage to the cams and panels.
- Turn the 15mm cams clockwise with a suitable screw driver (Do not use an electric screwdriver).

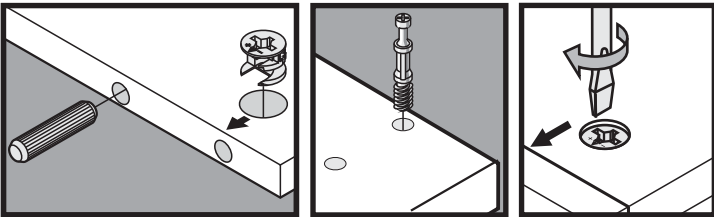

## Assembly- All Standard Units

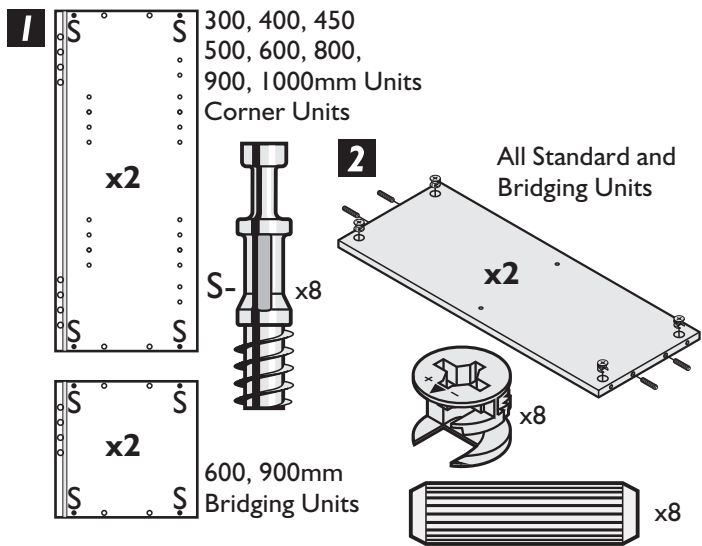

## 300, 400, 450, 500 & 600mm Wide Units

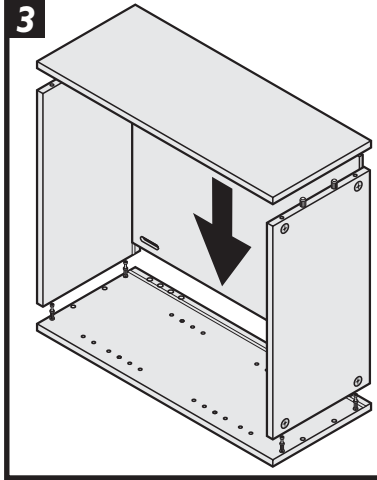

## Bridging Units

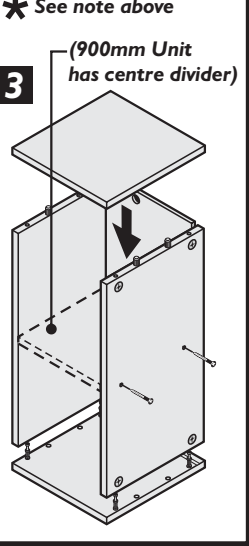

## 800, 900 & 1000mm Units

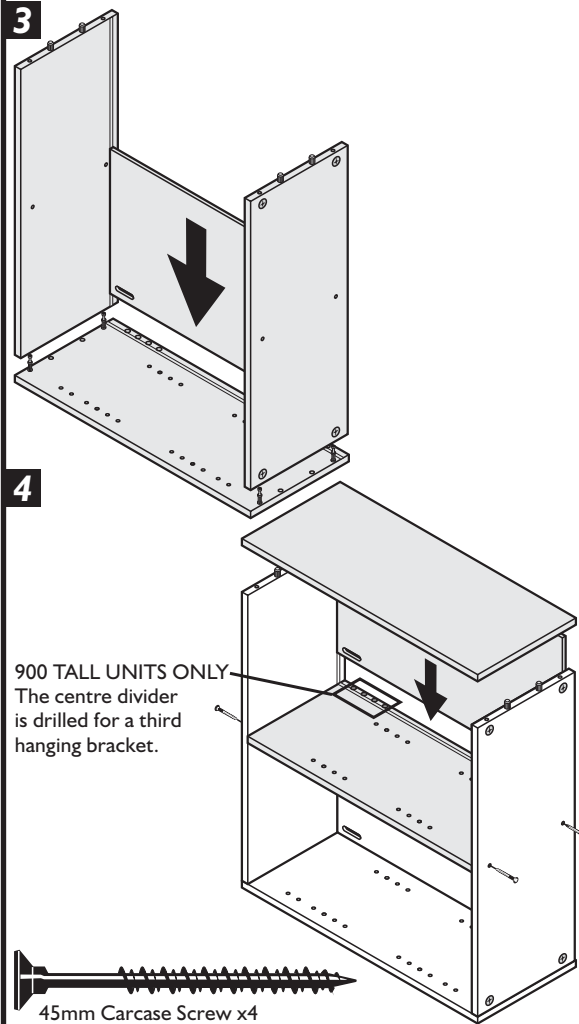

## Corner Units

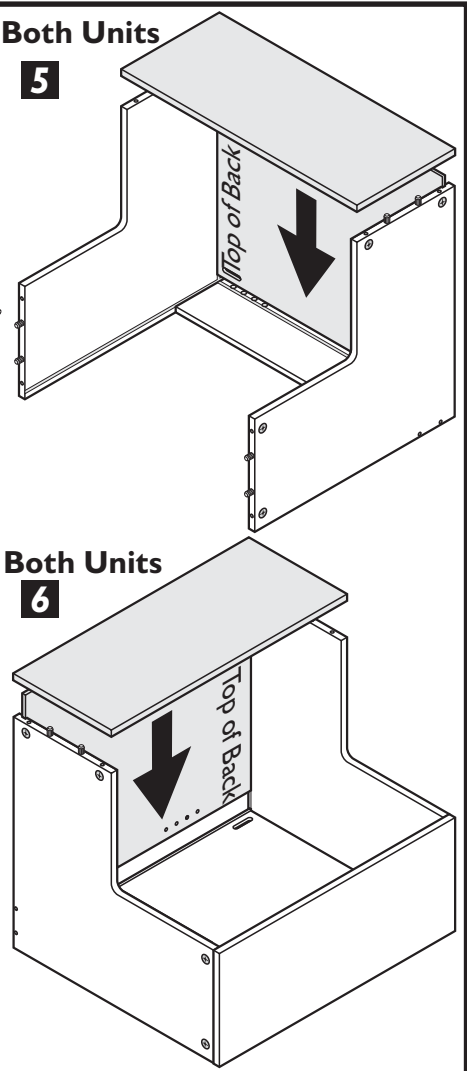
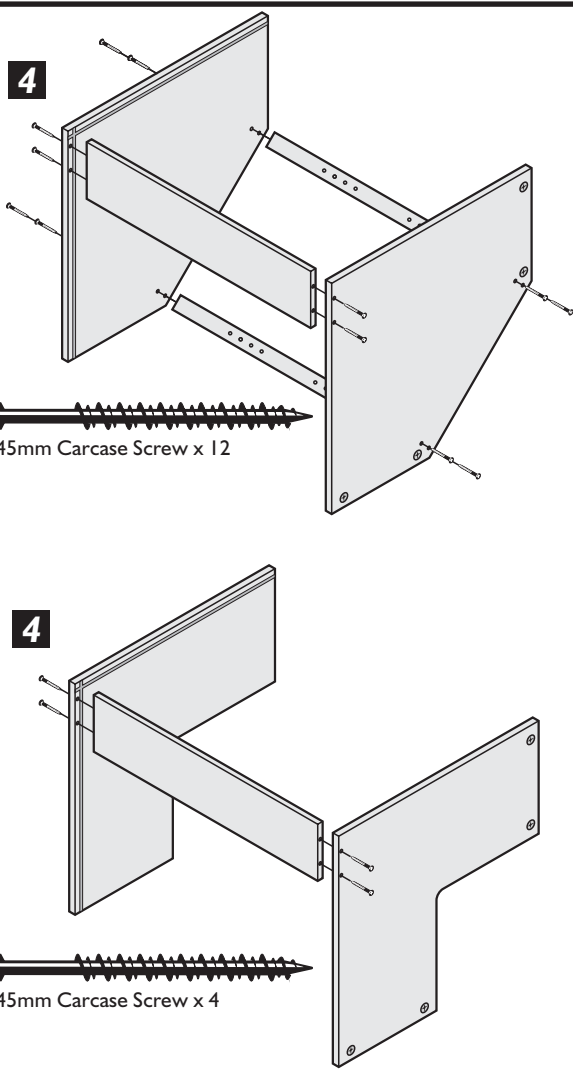
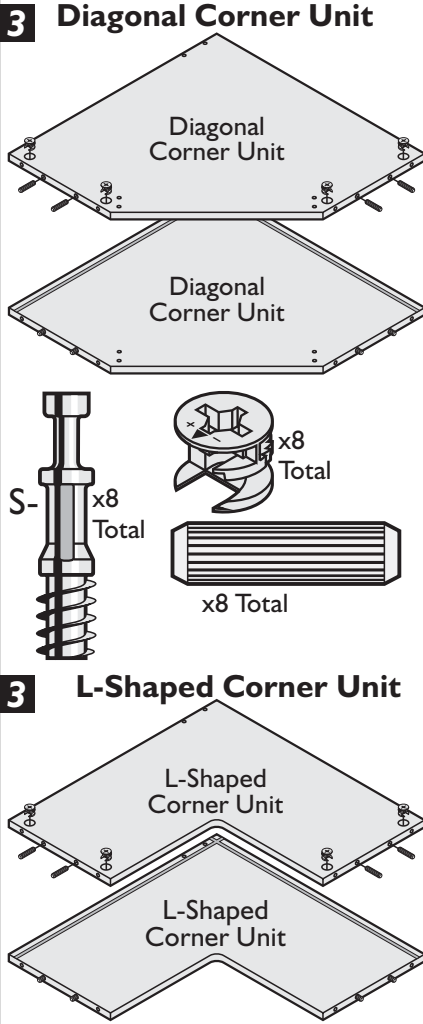

## Fitting Hanging Brackets

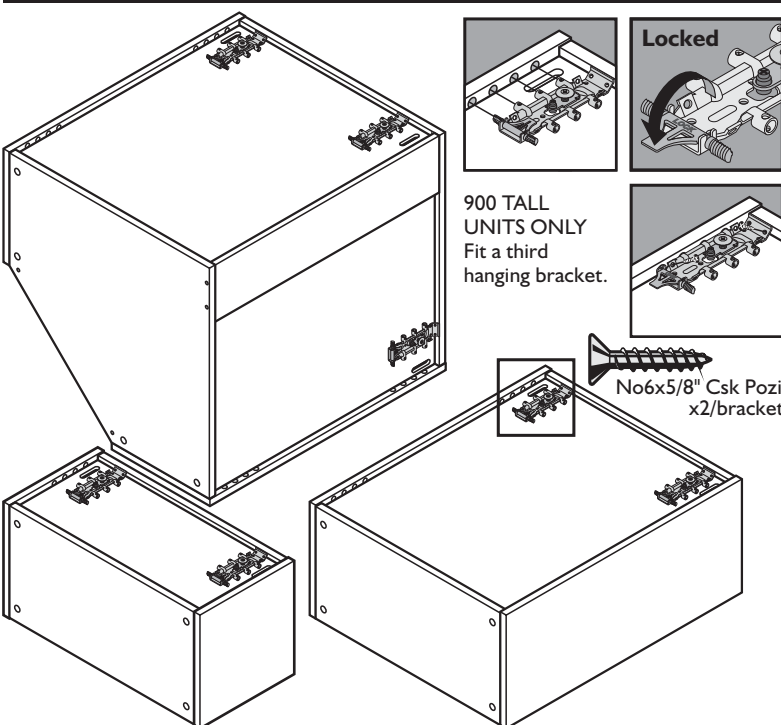

## 600 & 900mm Double Bridging Units

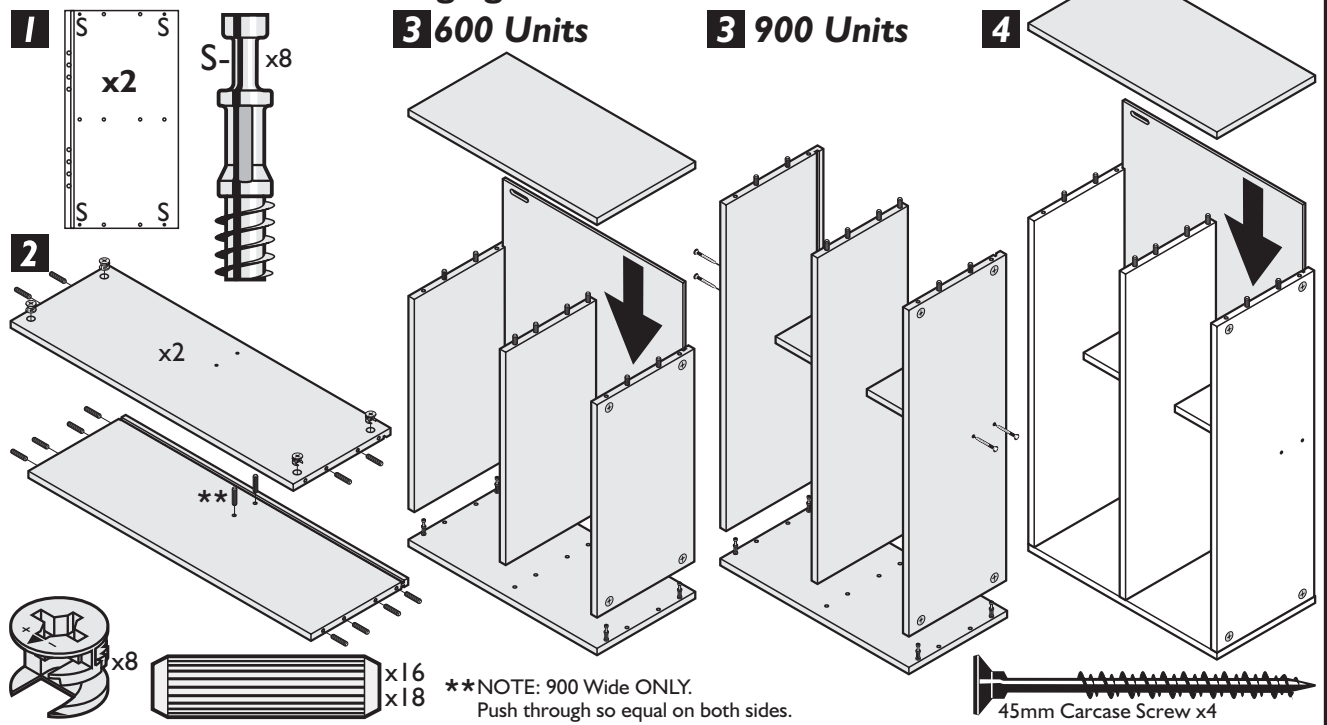



**1**

45mm Carcase Screw x 15

**2**

**3**

CB 0015  
Clip Hinge  
Mounting Plate x2

CG 0025-No6x3/4" Csk Pozi x4

**4**

CA 0099  
45° Clip Hinge x2

**NOTE:** Turn the unit over to fit at the other end of a run of units.

- Wall Hanging Brackets must be securely fastened to the wall with suitable fixings.
- The Wall Plate is used in one piece between units and snapped into 2 pieces if the Unit is at the end of a run. Notch the back of the units if the Wall Plate is used in one piece.
- The Wall Plates are positioned 80mm down from the top of the unit and either central between units or 20mm in from the end. The Wall Plates must be level.
- All 900mm tall double wall units (800, 900, 1000mm wide) must be fitted with a third hanging bracket fitted to the central divider to carry the extra weight when full. Fit an extra wall plate to suit.
- All Standard Units and most Decor Units and Accessories should be fastened together by using No.8 x 1 1/4" Csk Pozi Screws.
- Fixings can be concealed under hinge plates, drawer runners etc.

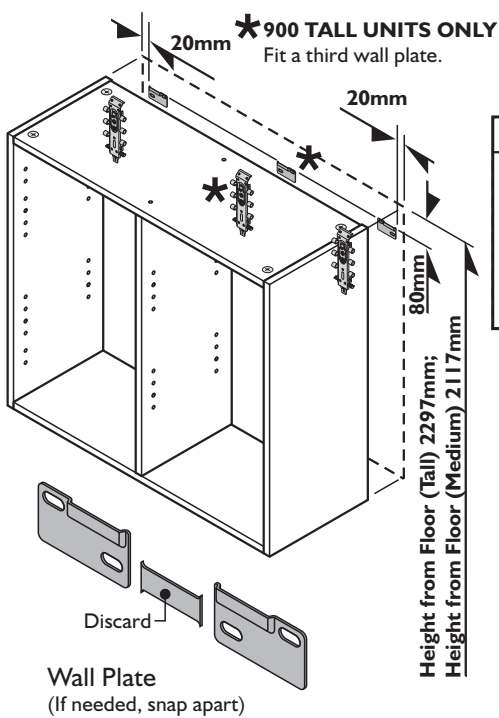

**Up and Down**

**In to Wall**

**Securing Pin (red)**

**NOTE:** Once the unit is levelled and adjusted, tighten the securing pin.

Technical drawing of a two-door cabinet. The drawing shows the front and side views. Dimensions are provided in millimeters (mm):

- Overall width: 1000
- Overall height: 1800
- Door width: 500
- Door height: 1600
- Internal width: 900
- Internal height: 1500
- Internal depth: 450
- Door thickness: 20
- Internal depth of the cabinet body: 400

The drawing also shows a detail of a screw used for assembly:

CG 0005-10x8x1 1/4" Csk Pozni

- Put the hinge and hinge plate together before fitting to the door as this makes finding the mounting holes in the end panels easy. The 110° and 170° Hinge are fitted and adjusted the same way.
- The door on single door units can open either left or right. Attach the hinges to one side of the door only.
- Put the shelf into position with 4 shelf pegs.
- Fit an anti-tip support into the hole at the back one space above the shelf.

**NOTE:** The corner post may need cutting down at the top to line up with the door.

**Do NOT** put a handle on this door

Plastic Washer x 4

45mm Carcase Screw x 4

(900mm Unit has centre divider)

Please find and open boxes with code **FLPBDG60/90**.  
Follow the enclosed instructions CT43 and drill for the  
new mechanism before assembling the unit.

